

Washroom Cubicles Solutions



*Feel Clean
Feel Good*



Vanity

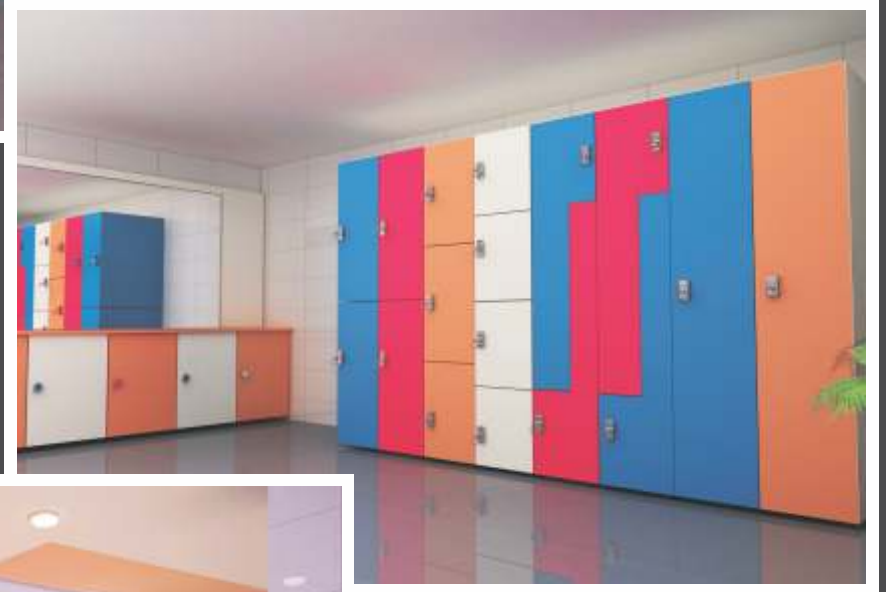

Locker



Shower Partition



Bathroom Cubicle



It's **Bold**

It's *Beautiful*



**Bold & Beautiful designs that appeals most to your personality.
Absolutely Strong Panels made of High Pressure Compact Laminates
with attractive systems to suit your needs.**



NEMA LD3-2005



INTRODUCTION

“**ROYALE TOUCHE**” began its modest journey from a single press - single unit facility way back in 1978 to grow into a multi unit multi press facility. It has never looked back since then. It has its presence in all the variants of Laminate production not alone in domestic market but in overseas markets too. Royale Touche products are optimal blend of style and strength. Besides spectrum of designs/colours, it has wider range of sizes and surfaces finish to offer.

“**ROYALE TOUCHE**” is proud to present **QBISS** Washroom cubicles with a back up of their 45 years of manufacturing experience of High Pressure Laminates. **QBISS** brings value addition in terms of cost, design and safe construction practice with proven capability of handling installation across India. The group produces over 18 million Sq. meter of High Pressure Laminates annually and has sizable presence in more than 50 countries around the World.

We offer **concept to completion** - using high quality compact sheets, hardware of International Standards coupled with highest quality of workmanship.

QBISS - Washroom cubicles are made from eco friendly material (HPL) offering strong and speedy construction, saving of space, low maintenance and improved hygiene. Washroom cubicles, Partition, Urinal divider are extensively used in most public utility/high traffic places such as Airport, Railway Station, Hospital, Educational Institution, Shopping Malls, Offices, Stadium and Commercial Establishments etc.

QBISS - Washroom cubicles system uses various options of international branded hardware fittings such as Nylon Polyamide, Zinc Alloy, Aluminium & Stainless Steel.

QBISS - Washroom cubicles are resistant to water, fire and scratches. In addition they come with an Anti Bacterial coating, making it an ideal product. Compact Sheets used for manufacture of QBISS confirms to EN 438 & CE ratings to meet stringent International Standards. It has Greenguard and Green Building Certification for eco-friendly and sustainable product.

ROYALE TOUCHE is committed to bring world class product and in time installation practices to India and is a India Power Brand.



COMPACT LAMINATE - WHAT IS IT?

It is a high pressure structural laminate, built up from multiple layers of kraft paper to produce a laminate in thickness from 2 to 25mm. It has a decorative face on both sides and is ideal for interior use in washroom cubicles, locker doors, wall panels and laboratory furniture. It is particularly suited to use in high humidity, high impact area.

With a density of 14Kg/m² (for 10mm thickness), Compact is impressively strong, damage resistant and has remarkable structural stability, requiring no substrate support in thickness over 6mm.

Our compact laminate conforms to EN438:4 and CE ratings and meets conformity with European Consumer Safety, health and environmental requirements

COMPOSITION

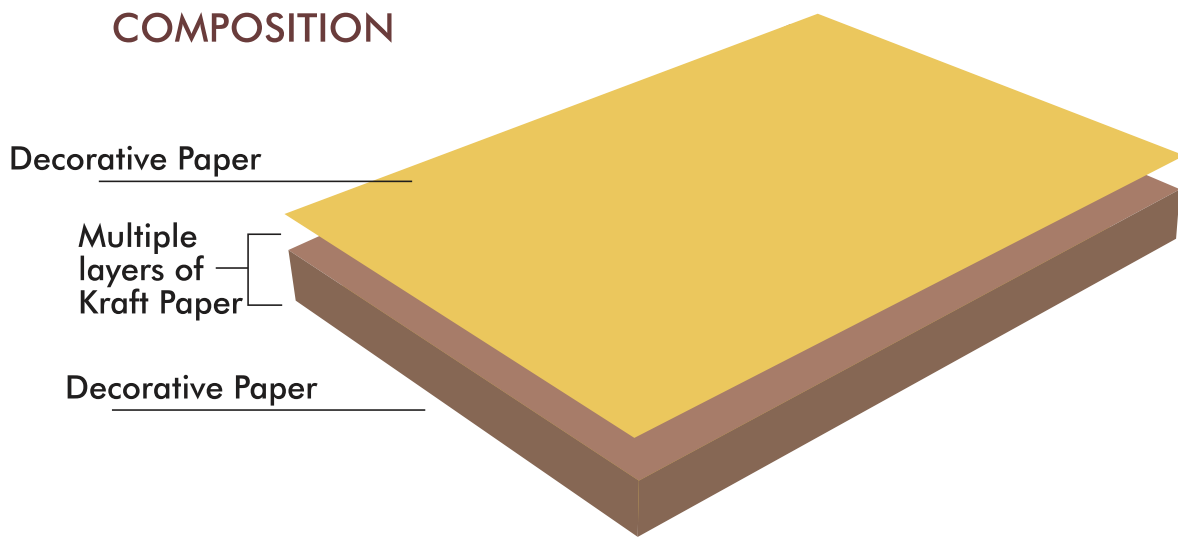

FEATURES



Made from Anti -Bacterial grade High Pressure Compact Laminate Panel confirming to EN438.



Accessories made of Nylon Polyamide, Stainless Steel and Aluminium of International Standard.



Available in Standard and Custom made Dimension.



Available in Compatible Dimensions for Physically Challenged (divyang) Person.



Wide colour range to choose from.



Hygienic and easily maintainable.



Providing better Durability, Performance and Aesthetic appeal.



Designed for Emergency situation handling.



Meeting International Fire Safety Norms.

ADVANTAGES

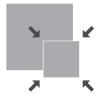

Space Saving – partition panels are only 12 mm thick as compared to conventional system like 150 mm thick brick wall.



Light Weight- partition systems reduces the load on building as compare to brick wall.



Easy Installation – 3 to 4 number Cubicles can be easily installed in a day.



Air Ventilation – Cubicles are properly design for air ventilation.

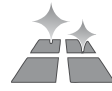

Easy to Floor Cleaning – Due to absence of corners, dust doesn't accumulate on the floor.



Resistant to Cigarette Burns.



Exceptional water, humidity and high temperature resistance.



Scratch and Stain Resistant.



**REDUCE
REUSE
RECYCLE**

WHY IS IT GREEN?



FSC certified Compact Sheet.



Greenguard Certified for indoor air quality and low emitting materials.



Less use of packaging material as compared to conventional building.



Materials can be reused at the end of product life style.



Life expectancy - atleast 25 years



Anti-Bacteria



Anti-Fungi



**Termite
Resistant**

AREA OF APPLICATION



Airport



Railway Station & Bus Station



Hospitals



School, College, University



Malls & Multiplexes



Hotels & Restuarants



Stadium & Sports Complex



Offices & Corporate Complex



Public Convieneances & Highway utilities



Exhibition Grounds & Changing Area

... usage area endless



Royal Collection

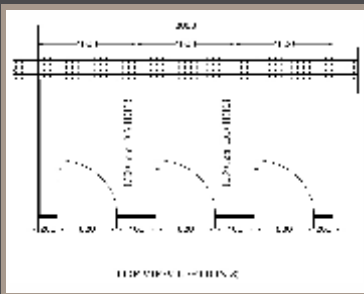

I - Type Unit

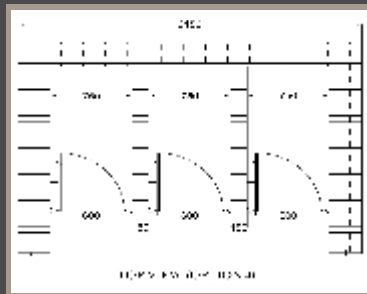

D - Type Unit

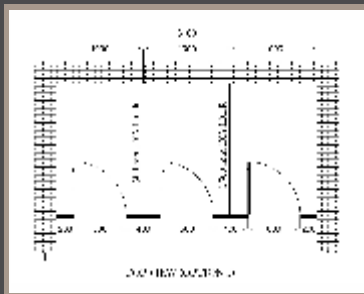

U - Type Unit

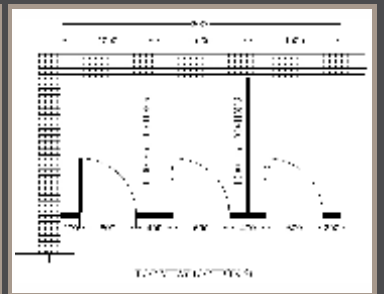

L - Type Unit





Classic Collection

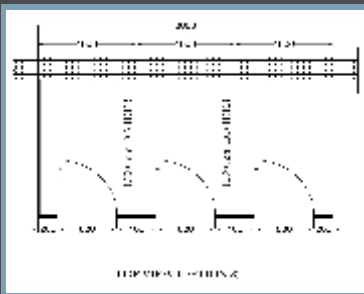

I - Type Unit

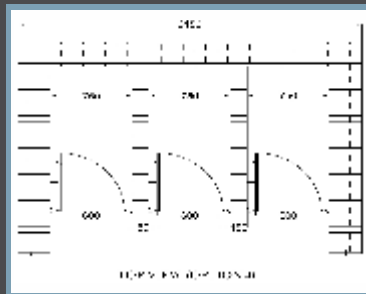

D - Type Unit

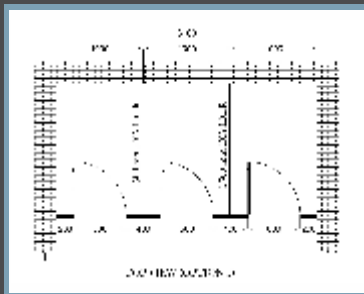

U - Type Unit

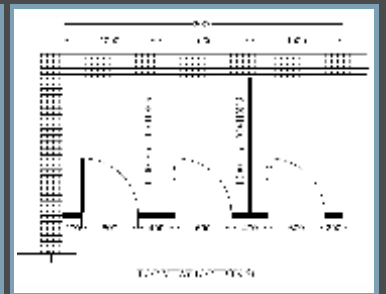

L - Type Unit



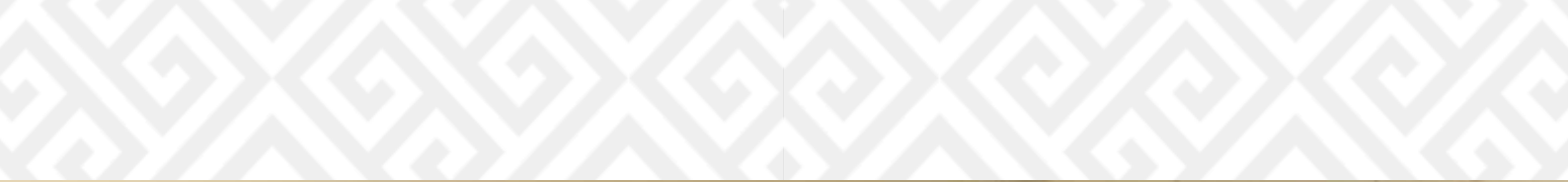

Elite Collection

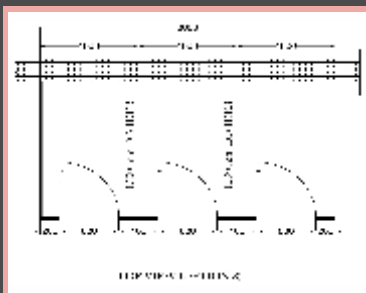

I - Type Unit

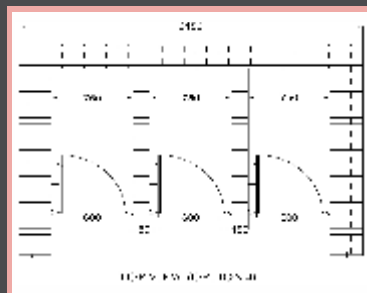

D - Type Unit

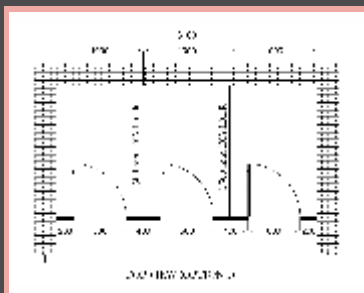

U - Type Unit

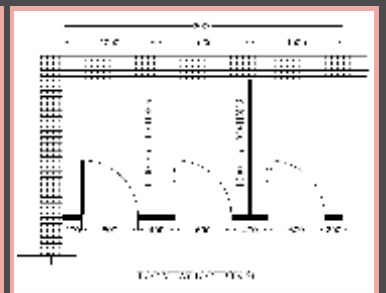

L - Type Unit



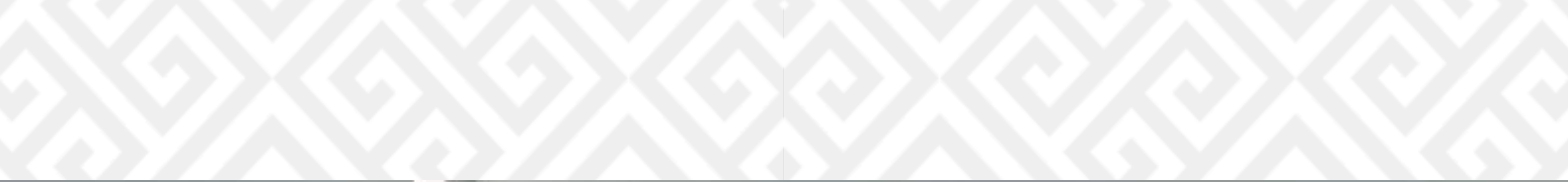

Supreme Collection

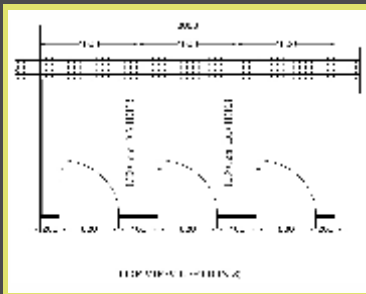

I - Type Unit

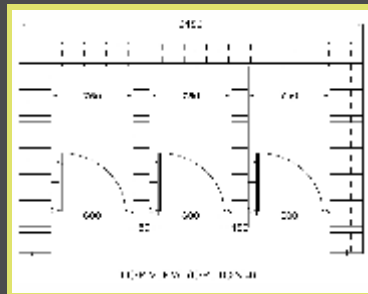

D - Type Unit

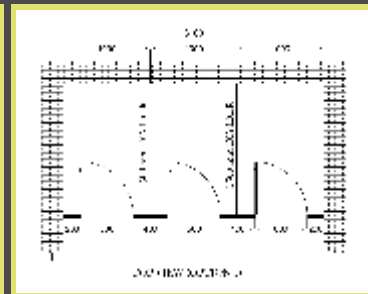

U - Type Unit

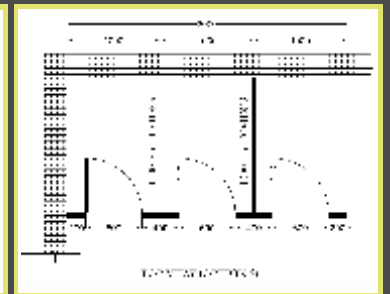

L - Type Unit





Eminent Collection

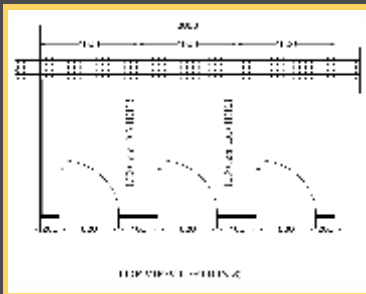

I - Type Unit

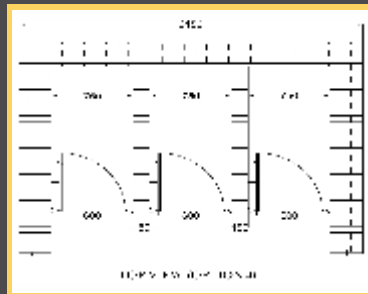

D - Type Unit

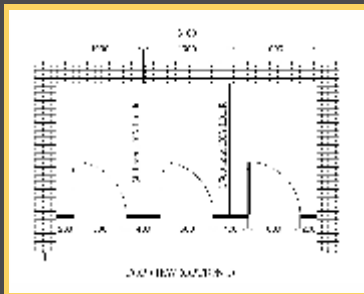

U - Type Unit

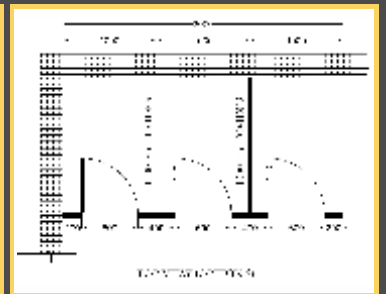

L - Type Unit



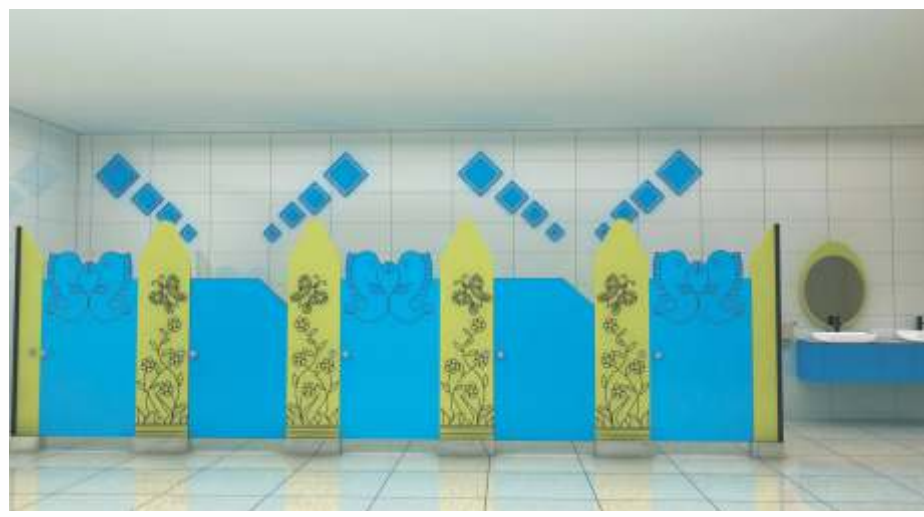

*Li'le Ones
Collection*

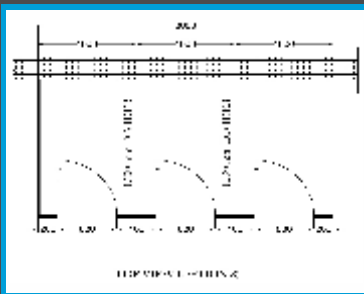

I - Type Unit

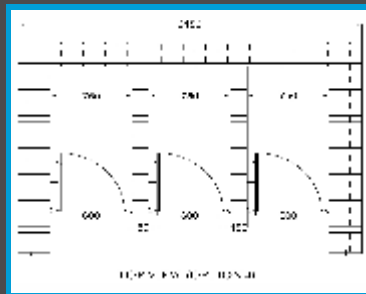

D - Type Unit

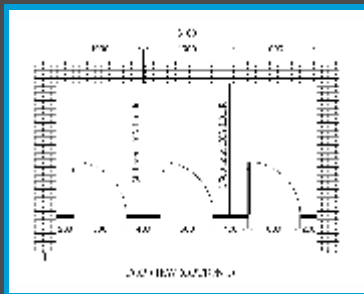

U - Type Unit

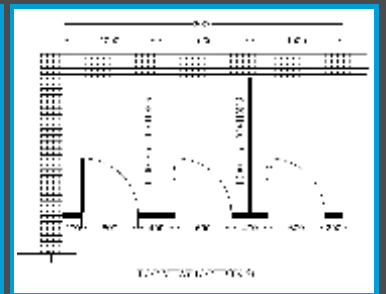

L - Type Unit



Standard Dimensions For Bathroom Cubicles

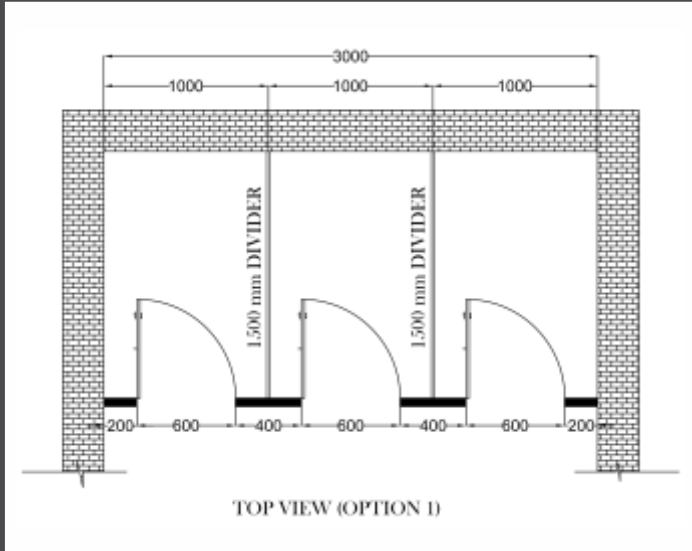

U - Type Unit

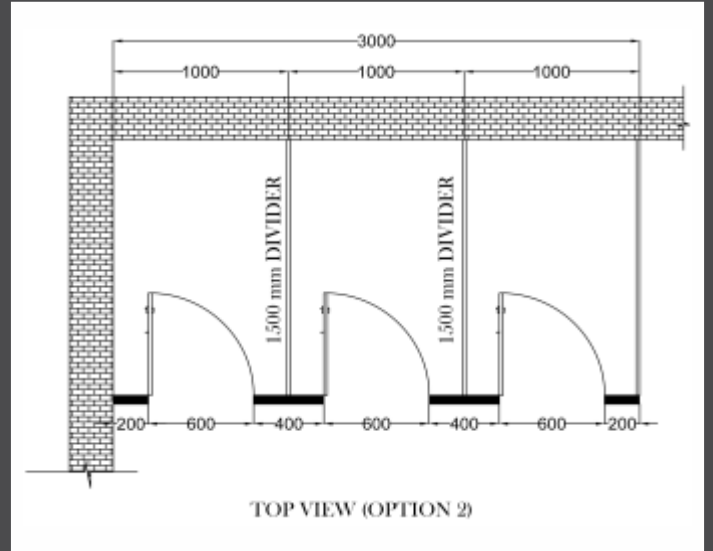

L - Type Unit

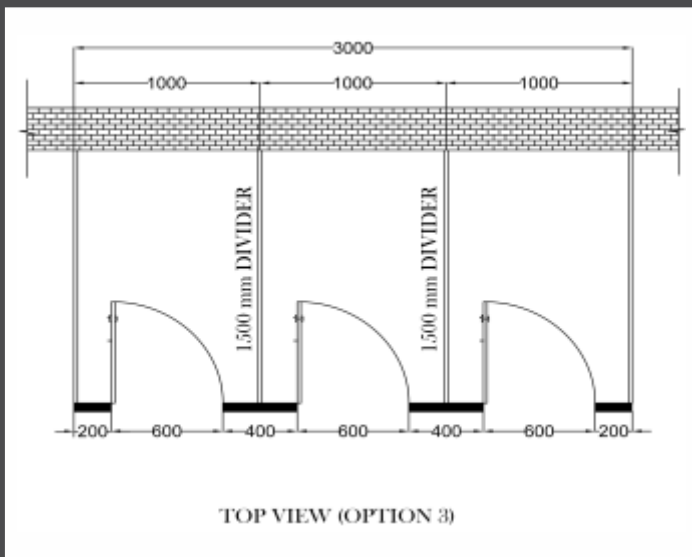

I - Type Unit

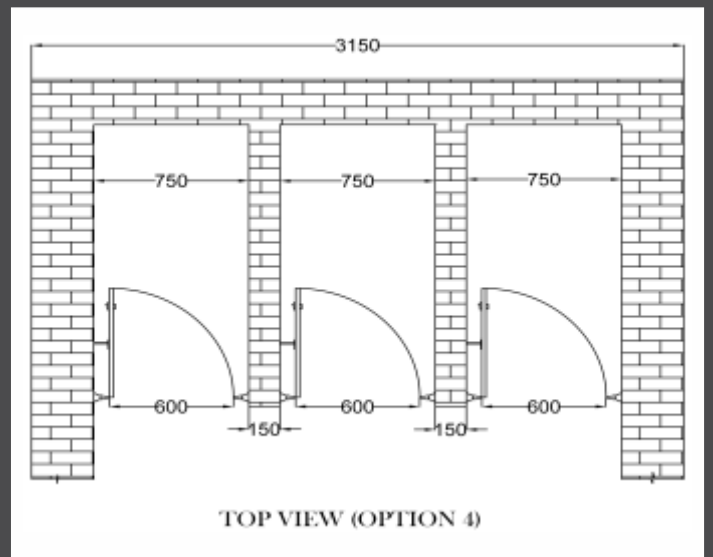

D - Type Unit



Section Drawing for Front Elevation

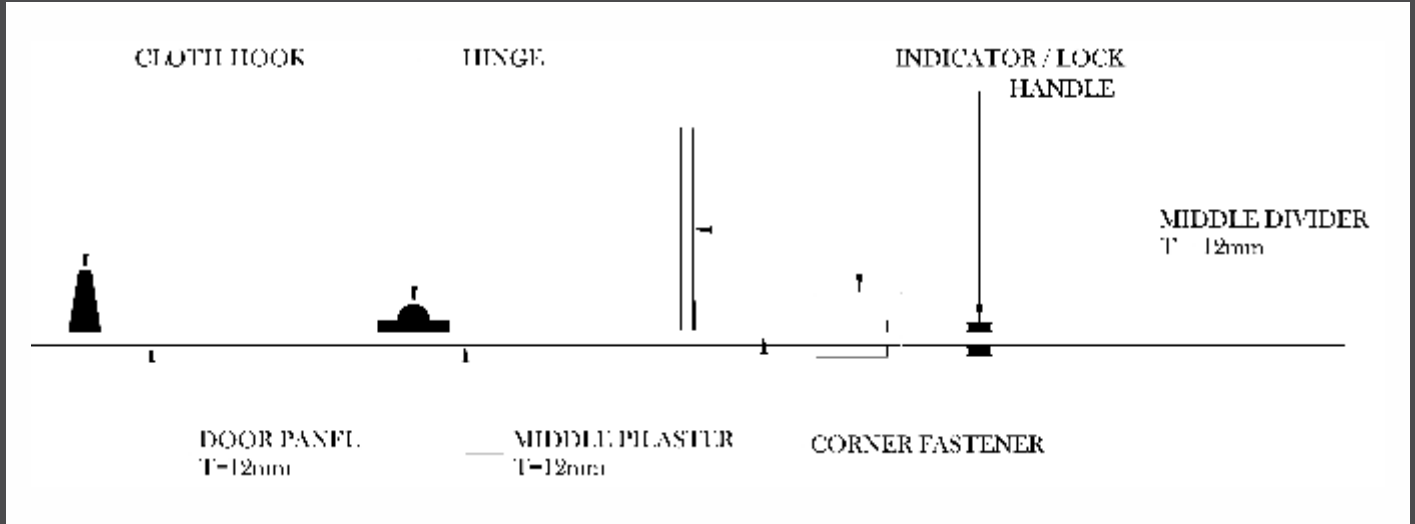

DIMENSION OF AREA	GENERAL		PHYSICALLY CHALLENGED
	English System	Indian System	
Width of Cubicle	1000	1000	1500
Depth of Cubicle	1500	1500	1750
Height of Divider	1830	1830	1830
Height of Door	1830	1830	1830
Width of Door	600	600	900
Height of Entire Cubicle	1980	1930	1980
Ground Clearance	150	100	150

** All dimentions in mm

Urinal Partition

Royale' Touche' also introduces Urinal Partition as a modern Washroom System. Manufactured in 12 mm thick High Pressure Compact Laminates with rust resistant Stainless Steel Hardware. Urinal Partition Panel are available in exciting colours and shapes. Light weight, durable, easy to install compared to the conventional system like glass or stone. HPL Panel are water and damp resistant. Resistant to scoring, cracking, breaking with no bacterial growth and also resistant to fire.

Dimensions

- Partition Height : 900 - 1000 - 1200 mm
- Depth: 450-600 mm
- Overall partition height 1350 mm
- Gap from ground floor: 150-450 mm

Hardware Detailing

Each divider panel is fixed with Stainless Steel-clamp which is used to attach the divider to the wall.

Hardware Fixing Details

Stainless steel L-clamp hardware fittings along with SU-304 screws are used to fix the urinal partitions on the wall.

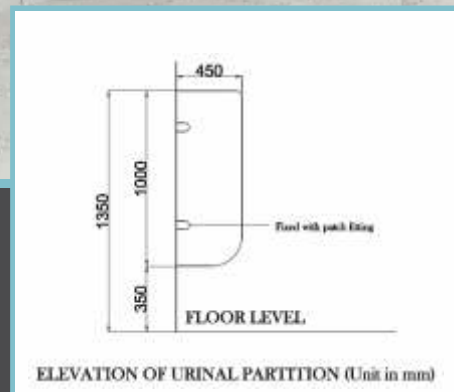

Model B

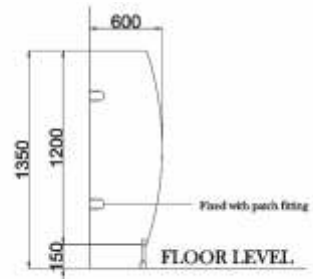

ELEVATION OF URINAL PARTITION (Unit in mm)

Model C



ELEVATION OF URINAL PARTITION (Unit in mm)

Model D

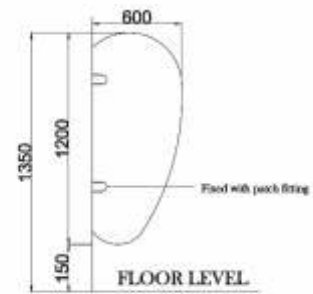

ELEVATION OF URINAL PARTITION (Unit in mm)

Model E



ELEVATION OF URINAL PARTITION (Unit in mm)

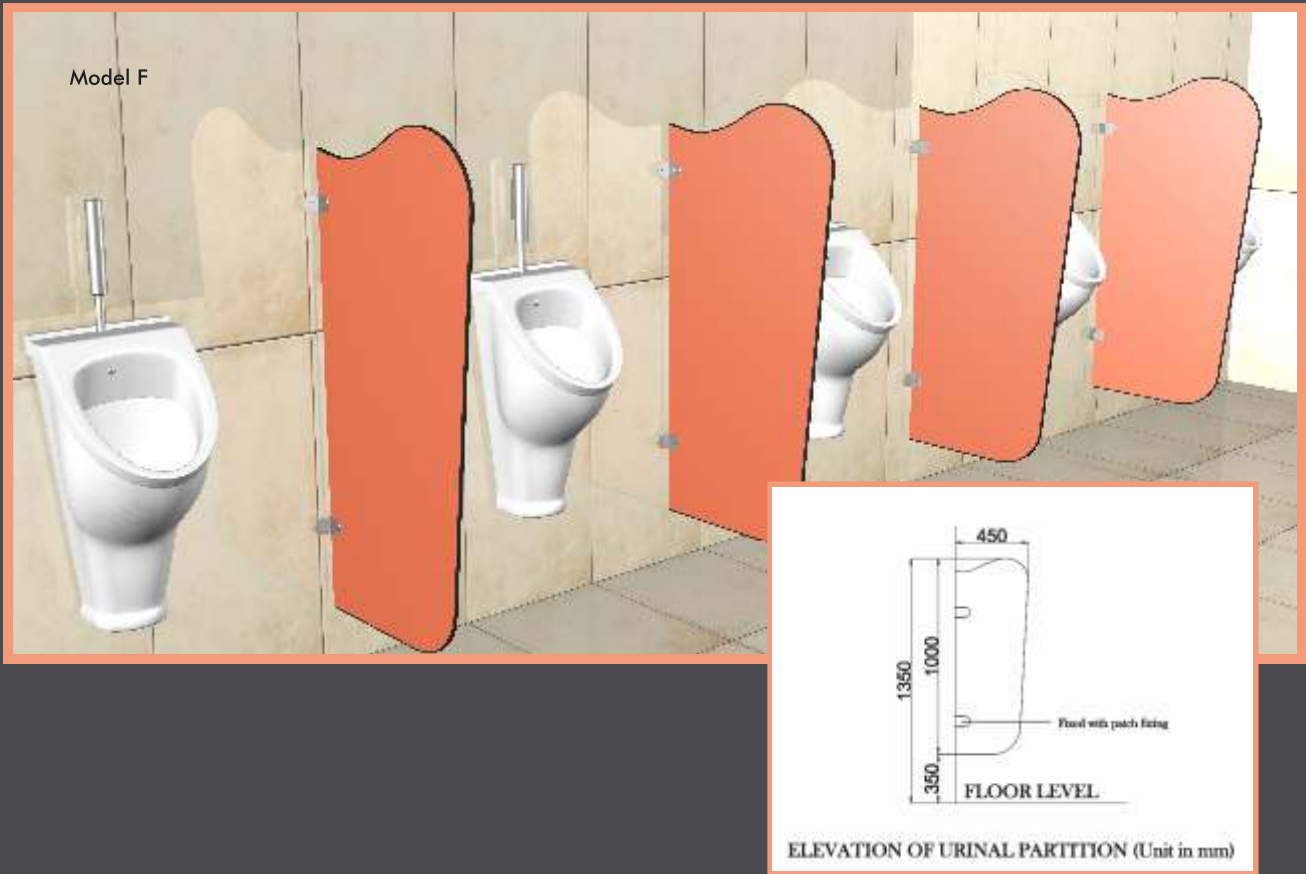

PERFORMANCE COMPARISON

Properties	MATERIAL		
	Granite / Marble	12 mm Frosted Toughened Glass	12 mm High Pressure Laminate Panel
Maintenance	Low, Non Stain & Scratch Proof	Difficult, Non-Stain & Srtches Proof	Easy to Clean, Non Stain & Scratch Proof, Anti-Bacterial
Water/Humidity	Resistant	Resistant	Highly Resistant
Fire/Heat	Resistant	Non Heat Resistant, Fire Proof	Heat Resistant, Fire Proof Class-B
Chemical	Resistant to Acid, Alkali Corrosion	Resistant to Acid, Alkali Corrosion	Resistant to Acid, Alkali Corrosion
Weight	Heavy	Heavy	Light
Durability	Low, Breakable	Low, Breakable	Very High, Strong
Aesthetics Look	Good	Monotonous	Colourful, Modern
Installation	Difficult	Easy	Very Easy
Re-Installation	Impossible	Risky, Fragail	Very Easy, Possible
Cost	Very High	High	Competitive

Lockers

1 Tier

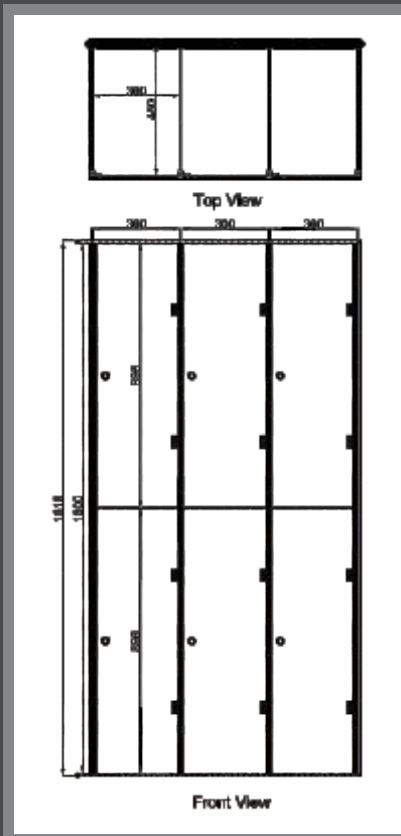
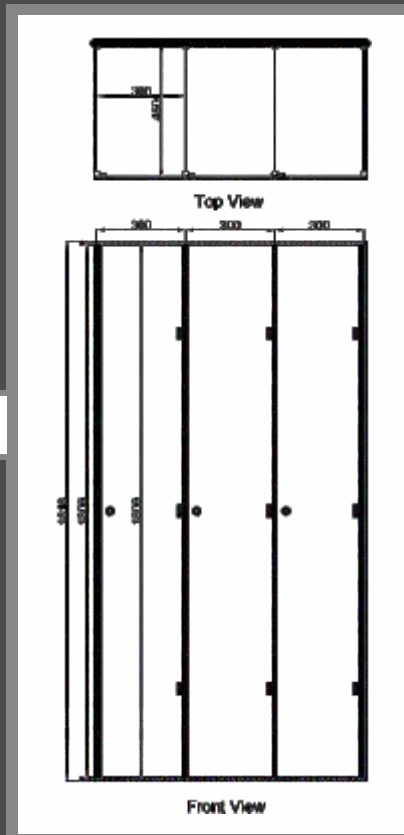

2 Tier

Lockers

3 Tier

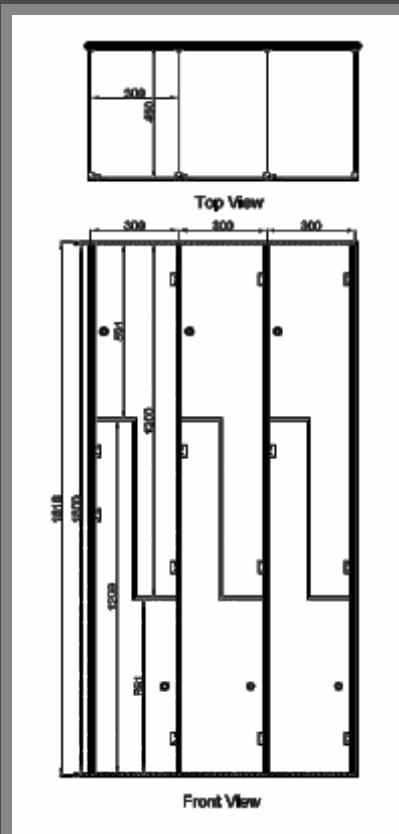
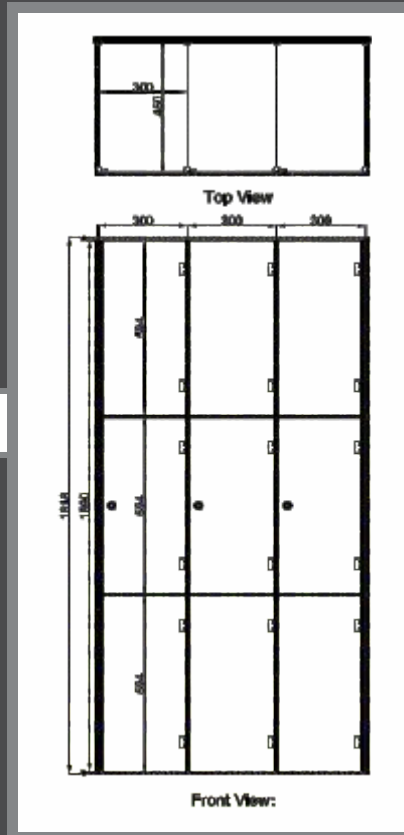

Z Type



Vanity



Shower Partition



Hardwares

All Qbiss product are equipped with International Branded Hardware for finest performance, durability and function. The hardware fittings and accessories are made of Nylon Polyamide, Zinc Alloy, Powder Coated Aluminium and Stainless Steel. Stainless Steel hardware confirming 304/316 grade and Nylon hardware are available in three different colours such as White, Black & Grey.

1. Adjustable Leg
2. Thumb Turn with Occupancy Indicator
3. Auto Return Hinge
4. Door Knob
5. Coat Hook
6. Head Rail Bracket
7. Head Rail
8. Panel Holder
9. Head Rail Connector

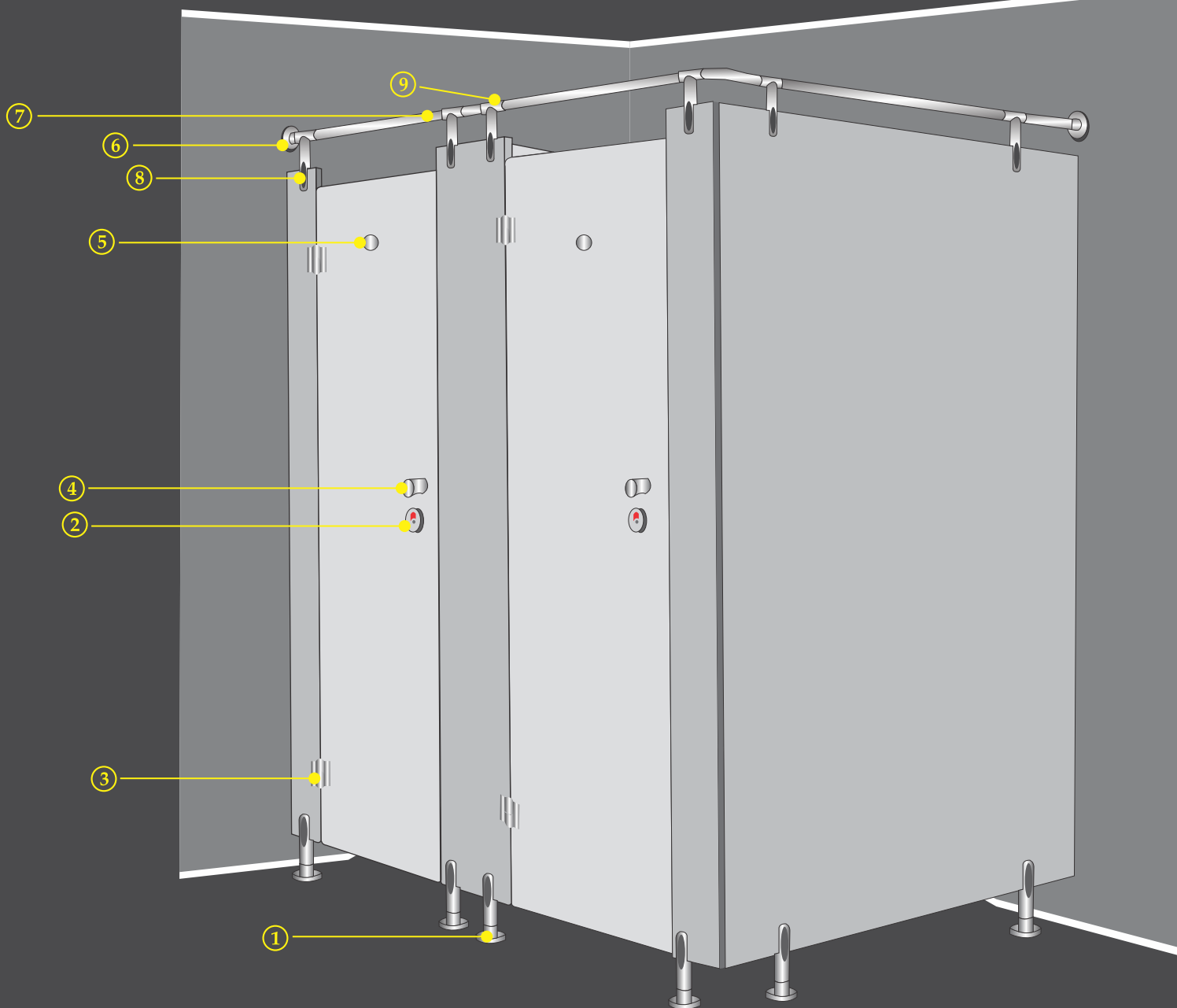

Standard Hardware positioning in cubicle

NYLON SERIES



Auto Return Hinge



Panel Holder



Coat Hook



Adjustable Leg



Thumb Turn with
Occupancy Indicator



Door Knob

Aluminium Section



Top Rail



Top Rail



Top Rail



Top Rail



U Channel

STAINLESS STEEL SERIES



Auto Return Hinge



Panel Holder



Coat Hook



Adjustable Leg



Thumb Turn with
Occupancy Indicator



Door Knob



Colour Range

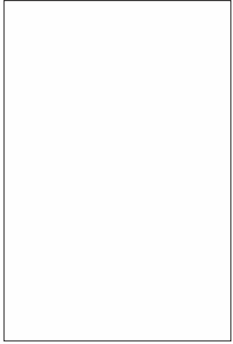

Arctic White RC 601XL

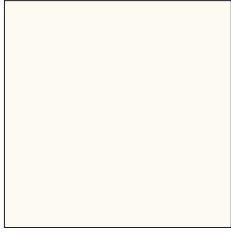

Egg White RC 13XL

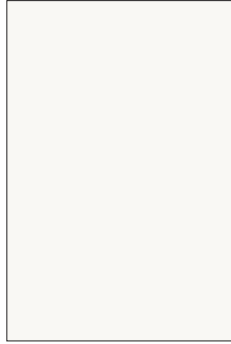

Cold White RC 851XL



Gothic Grey RC 861XL



Black RC 11XL

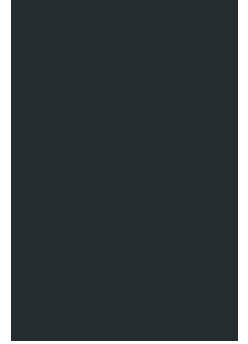

Dark Grey RC 603XL

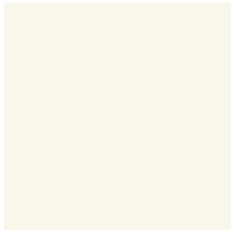

Polar White RC 858XL

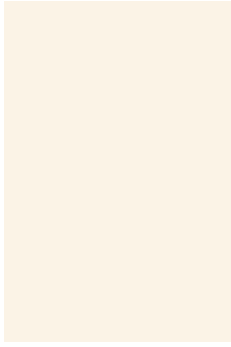

Mysore Ivory RC 17XL

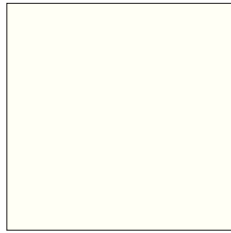

Frosty White RC 856XL

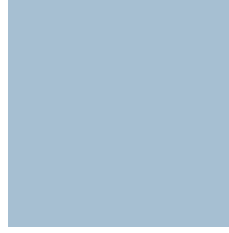

Greyish Blue RC 867XL

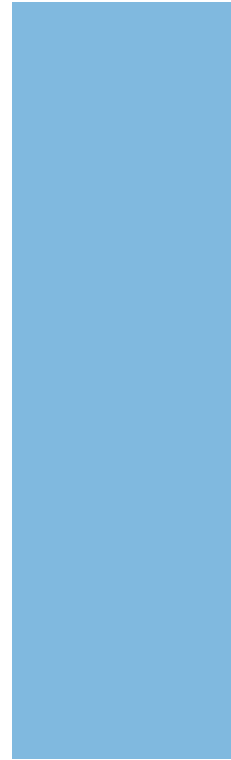

Sapphire Blue RC 876XL



Royale Blue RC 853XL

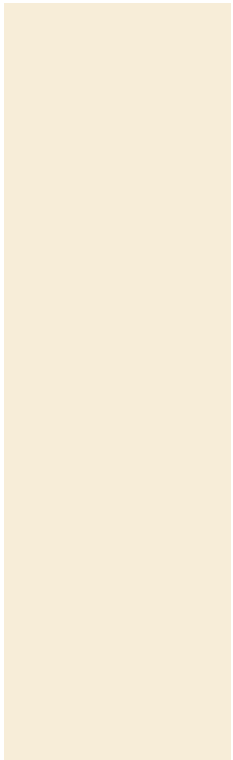

Ivory RC 855XL

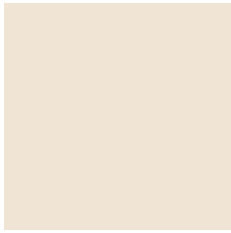

Peanut RC 859XL

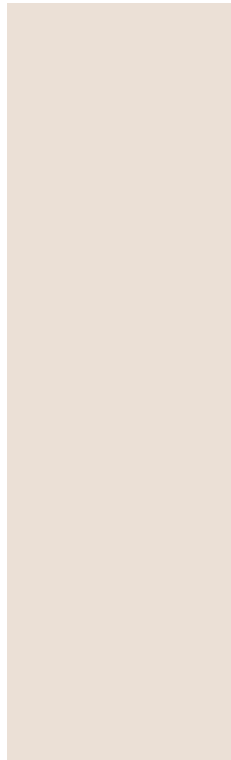

Beige RC 871XL

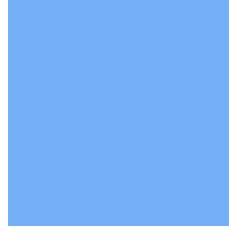

Blue RC 884XL

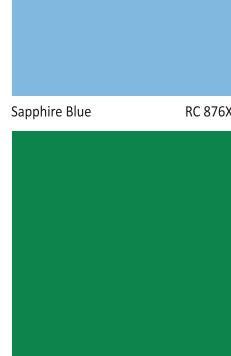

Green RC 869XL



Yellow RC 15XL

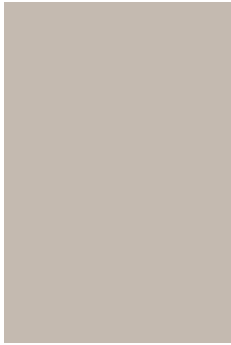

Creme Moyen RC 888XL



Parrot Green RC 865XL



Mango RC 864XL

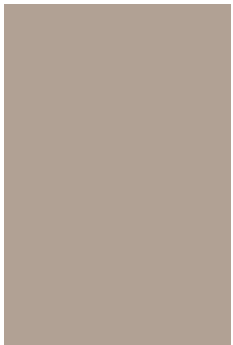

Brun Moyen RC 879XL

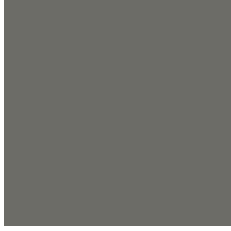

Slate Grey RC 862XL

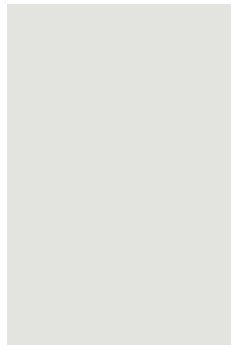

Silver Grey RC 860XL

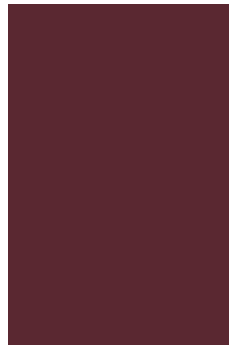

Burgundy RC 605XL

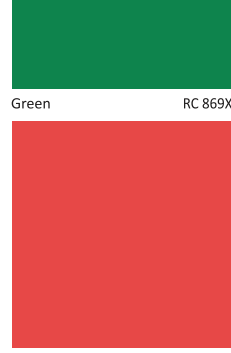

Red RC 19XL

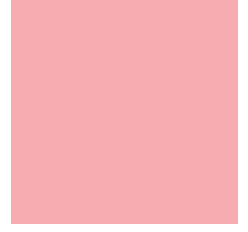

Candy Pink RC 875XL



D.Grey RC 873XL



Vodafone Red RC 872XL



Orange RC 857XL

Colour Range



Sapelli Mahogany RC 890XL



Urban Mahogany RC 897XL



Arusha Wenge RC 899XL



Ipu Mahogany RC 896XL



Oriental Cane (White) RC 902XL



Urban Teak RC 892XL



German Oak RC 893XL



Monnestr Oak RC 900XL



Lorraine Cherry RC 904XL

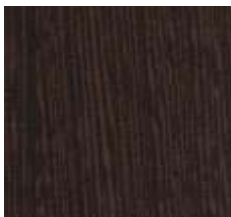

Straight Grained Wenge (Red) RC 901XL



Douglas Pine RC 894XL



Classic Planked Walnut RC 895XL



Balinese Oak RC 898XL



Scotia Oak RC 922XL



Mountain Larch RC 903XL



Noce Versailles RC 905XL



Thansau Maple RC 908 XL



Mangfall Beech RC 915XL



Criaza Pear RC 910XL



Noce Versailles RC 912XL



Moldau Acacia RC 907XL



Sonama Oak RC 913XL



Moldau Acacia RC 906XL



Bavarian Beech RC 909XL



Sonama Oak RC 914XL



Van Couver Maple RC 911XL

Colour Range



Mangfall Beech RC 915XL



Canyon Vintage Pine RC 640XL



Canyon Painted Metal RC 920XL



Osiris RC 923XL



Noce Versailles RC 917XL



Torano RC 921XL



Novecento Pine EXP 51



Alberta Maple RC 916XL

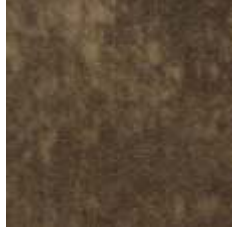

Belidor RC 646XL



Canyon Monument Oak RC 642XL



Tex Stone RC 925XL



Venice RC 926XL



Titan RC 874XL



Grey Titan RC 882XL



Puntinella RC 883XL



Manhattan RC 924XL



Almond Mix RC 877XL



Kubikus RC 657XL



Metalic Oxid RC 659XL

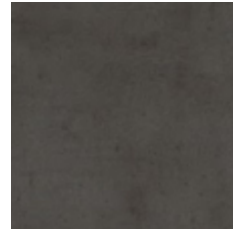

Manhattan RC 918XL

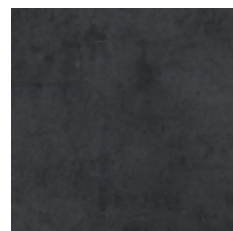

Manhattan RC 919XL



Tabo Slate RC 658XL



Granite RC 878XL



Stucco RC 651XL



Brooklyn RC 637XL

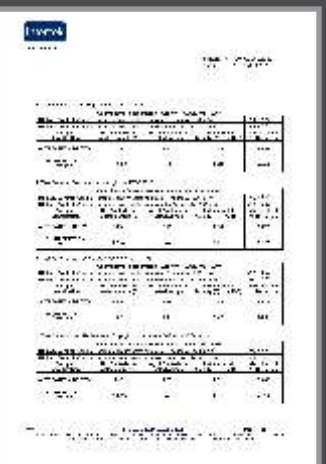
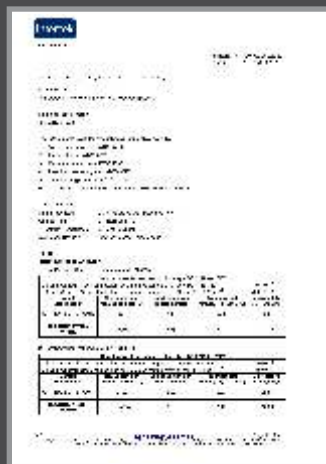
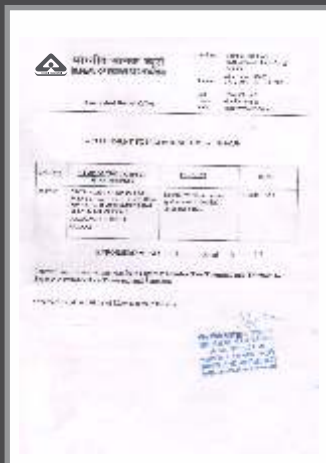

Technical Specifications

PROPERTIES	SPECIFIED VALUE AS PER EN - 438		ROYALE TOUCHE VALUE
Thickness	EN 438-2 section 5	According to the required thickness	02.0 < t < 03.0 mm : ± 0.20 mm 03.0 < t < 05.0 mm : ± 0.30 mm 05.0 < t < 08.0 mm : ± 0.40 mm 08.0 < t < 12.0 mm : ± 0.50 mm 12.0 < t < 16.0 mm : ± 0.60 mm 16.0 < t < 20.0 mm : ± 0.70 mm 20.0 < t < 25.0 mm : ± 0.80 mm
Density	ISO 1183-1	1.4	Min. 1.45GM/CM3
Resistance to Surface Wearing	EN 438-2:2005 section 10	Revolutions (min.) Starting Point Wear Value	560 750
Determination of Surface Scratch	EN 438-2:2005 section 25	Stress Rating (min.) Smooth Finished	Flat Surface 5N
Impact Resistance	EN 438-2 Big Ball section 21 CGS 2.0 <t<6.0 mm t>6.0 mm	Dropheight - 1800cm Diameter of Indentation - 10mm	1800cm 5mm
Determination of Resistance to Cleavage	EN 438-2:2005 section 24	Appearance / Rating (min.)	5
Resistance to dry heat (180° C)	EN 438-2:2005 section 16	Appearance Rating (min.) Gloss Finish Other Finish	4 (black samples/matte fini)
Water Vapour Resistance	EN 438-2:2005 section 14	Appearance / Rating (min.) Gloss Finish Other Finish	5 (black samples/matte fini)
Resistance to Boiling Water	EN 438 - 2 section 12	Mass Increase 5% Thickness Max 6 Appearance Less than 4	2.2%
Determination of Resistance to Burning Cigarettes	EN 438-2:2005 section 30	Level 3	Level 2
Resistance to Staining	CES Group 1 & 2 Group 3	Level 5 Level 4	Level 4 Level 5
Light Fastness (xenon)	EN 438-2:2005 section 27	Level 4 to 5	Level 4
Tensile Strength	EN ISO 527-2 CGS	60 MPA	Long - 120MPA Cross - 85MPA
Flexural Strength	EN ISO 178 EDS, EOF	80 MPA	120 - 140 MPA
Flexural Modulus	EN ISO 178 EDS, EOF	9000 MPA	9000 to 13000 MPA



NEMA LD3-2005

Maintenance

General Cleaning Instructions

1. Use a clean, damp, non-abrasive cloth and mild soap, non-bleach detergent or household cleaner.
2. Rinse with clear water, using a clean, non-abrasive cotton cloth.
3. Dry laminate surface with a soft, clean, non-abrasive cotton cloth.

For Stubborn Stains

1. Use a non-abrasive cleaner, detergent or general purpose cleaner, together with a short, soft bristle nylon brush to clean the stains gently.
2. Remove stains immediately. Allow cleaner to remain on the stain for several minutes before blotting area with a damp cloth and rinse.
3. Some solvents such as denatured alcohol, fingernail polish remover or paint thinner may also be used sparingly for very stubborn stains.

To Prolong The Lifespan of Toilet Cubicle Panels Surface

1. Do not use abrasive or polishing materials on the surface.
2. Do not use acidic or abrasive cleaning agents on surface that can damage the surface.
3. Remove paint, adhesive, synthetic resin and similar substances immediately with water or an organic solvent. Once these products are set, the removal of these substances may require processes that potentially damage the surface.

Warning:

Excessive use of solvents will damage the laminate finish and make it more susceptible to stains. Do not use cleaning agents containing acid, alkaline or sodium hypochlorite on laminate surface to avoid corrosion or permanent discolouration.





CROWN DECOR PVT.LTD.

6 Patel Avenue, 1st Floor,
S.G. Highway, Near Gurudwara,
Ahmedabad - 380 059, Gujarat, India.
Contact : +91 79 4001 7979

FACTORY

419/1, Radhe Industrial Estate,
Tajpur Road, Dist. Ahmedabad
Changodar - 382 213, Gujarat, India.

MARKETING OFFICE

2/A N Malayalay, 2nd Floor,
3 Woodburn Park, Kolkata - 700 020, India.
Ph : +91 33 4066 0166, 2283 0166
E-mail : kanishka@royaletouche.com